

AMF
Hatteras

43 Double Cabin

The seaworthy guest house.



The minute you step aboard the classic-lined Hatteras 43 Double Cabin, you'll find welcome surroundings.

The 43 places at your disposal gracious interiors, a carefully thought-out floor plan, fine craftsmanship and impeccable engineering.

Comfort? Welcome. The 43 Double Cabin greets you with a large, covered aft deck for open-air entertaining and piloting. An optional flying bridge can expand your boating horizons even more.

From here, steps lead down to the comforts of the 43's large, fully carpeted salon, full dinette and complete galley.



Forward portion of comfortable, airy Main Salon with convenient full dinette to port, galley to starboard. Companionway leads to Bow Stateroom.

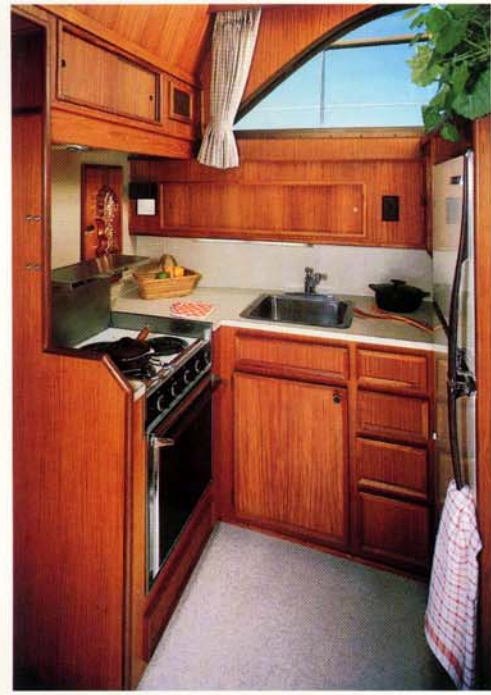

Galley is efficient "U" shape with excellent counter and storage space and full complement of appliances.



Aft portion of Main Salon. A great place to entertain or just plain relax. Also aft deck, companionway to Master Stateroom.



Practical convertible dinette seats four adults with ease, sleeps two with comfort.

As with the luxurious staterooms, these areas are paneled in rich wood—hand fitted and hand finished.

The aft deck provides open yet shaded relaxing. Features include dodger board all around, capped with traditional teak rail; side entry gates; side deck access and roomy helm station. A wet bar with ice maker is available.

Privacy? Welcome. To ensure privacy, Master and Guest Staterooms are at opposite ends of the 43. And each has its own head and shower.

The full beam, aft Master Stateroom features a queen-sized bed and generous storage. Including 2 hanging lockers and 18 drawers. The head is spacious and complemented by a stall shower.

The forward Guest Stateroom has wide vee berths and excellent storage featuring a full-length hanging locker. The forward head is convenient for day use but can also be privately used by stateroom guests.

Solid fiberglass hull? Stability? Dependability? Welcome. To that, let us add "Rugged", "Reliable" and "Efficient".

Because the Hatteras 43 Double Cabin is from the hands at Hatteras—the company built on a tradition of excellence in design and craftsmanship.

Your Hatteras dealer invites you to be *his* guest for a tour. He'll show you a level of style and comfort normally found only in larger yachts. A level which has made our 43 a perennial double cabin favorite.

Accept his invitation and we think you'll soon find yourself welcoming guests to very hospitable surroundings.

The Hatteras 43 Double Cabin.



Master Stateroom's head with stall shower. Sundries storage at vanity and separate linen storage.

Master Stateroom with queen-sized bed (twin berths available as an option on boats ordered with standard engines), two full-length hanging lockers, two built-in nine-drawer chests and plenty of luxurious comfort.



Guest Stateroom with Hatteras hallmarks: rich warm wood—hand-fitted and hand-finished; full-length hanging locker; excellent drawer space and wide, restful berths.



Guest head and shower with mirrored medicine chest and generous counter space.

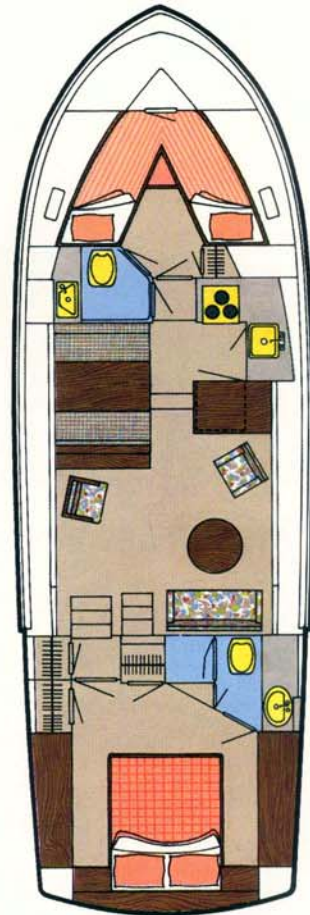



The Hatteras 43 Double Cabin.



AMF

Hatteras Yachts

High Point, North Carolina 27261 U.S.A.

43DC 0281 05
Printed in U.S.A.

AMF Hatteras Yachts reserves the right to make styling, design, equipment and construction changes without notice. Also, prices are subject to change without notice. Some items shown may be optional. Hatteras is a registered trademark of AMF Incorporated. © 1981 AMF Incorporated.